

GENERAL DESCRIPTION OF PRODUCT

Trademarks:

Canon Inc.'s trademark, logos, product names, service marks and those trademark, logos, product names, service marks licensed to Canon Inc. by any of its affiliate or subsidiary are registered or unregistered marks of Canon Inc. or such affiliate or subsidiary in Japan and/or other countries.

Adobe, the Adobe logo, Acrobat, the Acrobat logo and Reader are either registered trademarks or trademarks of Adobe Systems Incorporated in the United States of America and/or other countries. All other trademarks, product names, service marks are generally either registered or unregistered marks of their respective owners.

Copyright:

All copyrights in the content of this Service Manual are owned or controlled by Canon Inc. You are not permitted to copy, reproduce, download, modify, adapt or translate in any way the content of this Service Manual for any purpose other than the purpose contemplated herein without prior written consent of Canon Inc.

CONTENTS

1 Development Objectives	
1-1 Summary of Main Features	1
1-2 Main Specification Comparison	3
1-2-1 SELPHY CP710 and CP500	3
1-2-2 SELPHY CP510 and CP400	4
2 Exterior	
2-1 Exterior Photos	5
2-2 5-dimensional Diagram	6
2-3 Nomenclature	7
3 Specifications	
3-1 Product Specifications	8
3-2 System Diagram	10
3-3 Direct Print	11
3-3-1 PictBridge Features and Corresponding Camera Support	11
3-3-2 The Connection between Digital Cameras and Printers	13
4 Accessories	
4-1 List of Accessories	14
4-1-1 Ink, paper	14
4-1-2 Paper Cassettes	14
4-1-3 Battery Pack	14
4-1-4 Compact Power Adapter	14
4-1-5 Bluetooth Unit	14
4-1-6 Wireless Adapter	14
4-2 Accessory Compatibility	15

1 Development Objectives

1-1 Summary of Main Features

How to read this summary

- NEW!**New features introduced with the SELPHY CP710/CP510→ Highlighted in red
- ◆Features different from the SELPHY CP500/CP400 → Highlighted in red
-Features carried over from the SELPHY CP500/CP400

High Image Quality

- Dye-sublimation system provides exceptional gradations
- High resolution of 300 × 300 dpi
- Durable protective print overcoating (equivalent to 100-year print)
 - Simulation results based on storage in a dark place at 23°C (73.4°F) and 50% RH.
- Automatic dynamic-range correction (when using PictBridge)

Full Features and Ease of Operation

NEW! Canon Direct Print (from a memory card) support (SELPHY CP710 only)

- Three types of memory card slot
- 1.5" color LCD monitor for image verification
- Printing operations enabled from the printer itself

NEW! Wireless printing via wireless communication (Bluetooth / wireless LAN)*

* Optional Bluetooth unit / wireless Print adapter required

NEW! Equipped with a tripod socket*

* Support for displays at local dealers

NEW! High-speed printing at 60 seconds or less (for Canon Direct Print connection, postcard size print)

NEW! Retractable camera connection cable in the printer

- ◆ PictBridge support: Support for all PictBridge printing features
 - File name print
- ◆ Support for four print sizes* including wide size (100 × 200 mm)
 - Supports full-area printing with a PictBridge connection

* Paper cassettes are not supplied for all print sizes. Because the included paper cassette types differ depending on product destination, it may be necessary to purchase additional paper cassettes (optional) for other paper sizes.

◆ Battery powered operation

- Optional Battery Pack NB-CP2L

◆ Application software and drivers

- Accepts full-sized label paper (credit-card size) for printing photos to labels
- Supports printing of eight removable copies of the same image on one credit-card size sticker sheet
- Ink, paper, and paper cassette are compatible with previous models

New Design

NEW! A new design that conveys ease of use while highlighting its many features (SELPHY CP710)

NEW! A classy design for a low-end model, emphasizing compatibility with the SELPHY CP710 (SELPHY CP510)

Compact

- ◆ Compact design: Under 1500 cm³ in volume and Approx. 980g (34.6 oz.) in weight (SELPHY CP710)
Under 1500 cm³ in volume and Approx. 940g (33.2 oz.) in weight (SELPHY CP510)

1-2 Main Specification Comparison

1-2-1 SELPHY CP710 and CP500

• Note: Colored table items and text in red show changes from SELPHY CP500.

		SELPHY CP710	SELPHY CP500
Printing Method		Dye-sublimation thermal print method (with overcoating)	
General Specifications	Resolution	300 × 300 dpi	
	Gradation	256 levels per color	
	Ink	Dedicated cartridge (Y, M, C and overcoating material)	
	Paper	Dedicated paper (Postcard size; L size; Credit-card size; Credit-card size with full-sized adhesive label; 8-piece adhesive sticker; Wide size)	
	Feeding System	Automatic feed from the paper cassette	
	Paper Eject System	Automatic paper ejection on the paper cassette	
	Printing Modes/Sizes	Postcard size, borderless: 100.0 × 148.0 mm (3.94 × 5.83 in.) Postcard size, bordered: 91.4 × 121.9 mm (3.60 × 4.80 in.) L size, borderless: 89.0 × 119.0 mm (3.50 × 4.69 in.) L size, bordered: 79.2 × 105.3 mm (3.12 × 4.15 in.) Credit-card size, borderless (including label paper): 54.0 × 86.0 mm (2.13 × 3.39 in.) Credit-card size, bordered (including label paper): 50.0 × 66.7mm (1.97 × 2.63 in.) 8-piece stickers (per one label): 22.0 × 17.3 mm (0.87 × 0.68 in.) Wide size*, borderless: 100.0 × 150.0 mm (3.94 × 5.91 in.) The SELPHY CP710 supports full-area printing (100.0 × 200.0 mm (3.94 × 7.87 in.)) with a PictBridge connection.	
Interface	Printing Features	Single Image Print Several Selected Image Print DPOF Image Print All Image Index Print All Image Print Cropping Print Copies Date Print Paper Size* ¹ Layout print (fixed size) Layout print (N-up) ¹ File Name Print² Borderless ID Photo Print* ³ Movie Print* ³ * ¹ Not available with Canon Direct Print * ² DPOF file number print only with Canon Direct Print * ³ Canon specifications. Camera must also support this feature. Only available when connecting with Canon Direct Print.	Single Image Print Several Selected Image Print DPOF Image Print All Image Index Print All Image Print Cropping Print Copies Date Print Paper Size* ¹ Layout print (fixed size) Layout print (N-up) ¹ File Name Print (DPOF File Number Print only) Borderless ID Photo Print* ² Movie Print* ² * ¹ Not available with Canon Direct Print * ² Canon specifications. Camera must also support this feature. Only available when connecting with Canon Direct Print.
	Memory card slots	Compact Flash card slot SD memory card / Multimedia card slot Memory Stic slot • Image verification from LCD monitor	Not supported
Product Specifications	External	Format	USB
		Connection (cable)	For camera: retractable USB cable in the printer , or USB interface cable bundled with the camera (Connector on the printer is Type A) For computer: general purpose USB cable (Connector on the printer is Type B)
	Wireless		Bluetooth • Optional Bluetooth Unit BU-20 required Wireless LAN • Optional wireless Print Adapter WA-1(N)(E) required
Product Specifications	Operating Environment		5 - 40°C, 20 - 80% RH
	Power Source		DC 24 V : Compact Power Adapter CA-CP200 : Battery Pack NB-CP2L (22.2 V)
	Power Consumption		60 W or less (Standby: 4 W or less)
	Dimensions		178.0 × 131.0 × 63.0 mm (7.01 × 5.16 × 2.48 in.)
	Weight		Approx. 980 g (34.6 oz.)

1-2-2 SELPHY CP510 and CP400

• Note: Colored table items and text in red show changes from SELPHY CP400.

			SELPHY CP510		SELPHY CP400	
Printing Method			Dye-sublimation thermal print method (with overcoating)			
General Specifications	Resolution		300 × 300 dpi			
	Gradation		256 levels per color			
	Ink		Dedicated cartridge (Y, M, C and overcoating material)			
	Paper		Dedicated paper (Postcard size; L size; Credit-card size; Credit-card size with full-sized adhesive label; 8-piece adhesive sticker; Wide size)			
	Feeding System		Automatic feed from the paper cassette			
	Paper Eject System		Automatic paper ejection on the paper cassette			
	Printing Modes/Sizes		Postcard size, borderless: 100.0 × 148.0 mm (3.94 × 5.83 in.) Postcard size, bordered: 91.4 × 121.9 mm (3.60 × 4.80 in.) L size, borderless: 89.0 × 119.0 mm (3.50 × 4.69 in.) L size, bordered: 79.2 × 105.3 mm (3.12 × 4.15 in.) Credit-card size, borderless (including label paper): 54.0 × 86.0 mm (2.13 × 3.39 in.) Credit-card size, bordered (including label paper): 50.0 × 66.7 mm (1.97 × 2.63 in.) 8-piece stickers (per one label): 22.0 × 17.3 mm (0.87 × 0.68 in.) Wide size*, borderless: 100.0 × 150.0 mm (3.94 × 5.91 in.) *The SELPHY CP510 supports full-area printing (100.0 × 200.0 mm (3.94 × 7.87 in.)) with a PictBridge connection.			
Printing Features		Single Image Print Several Selected Image Print DPOF Image Print All Image Index Print All Image Print Cropping Print Copies Date Print Paper Size*1 Layout print (fixed size) Layout print (N-up) ¹ File Name Print² Borderless ID Photo Print*3 Movie Print ³ ^{*1} Not available with Canon Direct Print ^{*2} DPOF file number print only with Canon Direct Print ^{*3} Canon specifications. Camera must also support this feature. Only available when connecting with Canon Direct Print.		Single Image Print Several Selected Image Print DPOF Image Print All Image Index Print All Image Print Cropping Print Copies Date Print Paper Size*1 Layout print (fixed size) Layout print (N-up) ¹ File Name Print (DPOF File Number Print only) Borderless ID Photo Print*2 Movie Print ² ^{*1} Not available with Canon Direct Print ^{*2} Canon specifications. Camera must also support this feature. Only available when connecting with Canon Direct Print.		
Interface	Memory card slots		Not supported			
	External	Format	USB			
		Connection (cable)	For camera: retractable USB cable in the printer , or USB interface cable bundled with the camera (Connector on the printer is Type A) For computer: general purpose USB cable (Connector on the printer is Type B)		For camera: USB interface cable bundled with the camera (Connector on the printer is Type A) For computer: general purpose USB cable (Connector on the printer is Type B)	
	Wireless		Bluetooth • Optional Bluetooth Unit BU-20 required Wireless LAN • Optional wireless Print Adapter WA-1(N)(E) required		Not supported	
Product Specifications	Operating Environment		5 - 40°C, 20 - 80% RH			
	Power Source		DC 24 V : Compact Power Adapter CA-CP200 : Battery Pack NB-CP2L (22.2 V)		DC 24 V : Compact Power Adapter CA-CP200	
	Power Consumption		60 W or less (Standby: 4 W or less)			
	Dimensions		178.0 × 131.0 × 63.0 mm (7.01 × 5.16 × 2.48 in.)		178.0 × 120.0 × 58.6 mm (7.01 × 4.84 × 2.17 in.)	
	Weight		Approx. 940 g (33.2 oz.)		Approx. 820 g (28.9 oz.)	

2 Exterior

2-1 Exterior Photos



Photo 3 SELPHY CP710 Top



Photo 4 SELPHY CP510 Top



Photo 5 SELPHY CP710 Front



Photo 6 SELPHY CP510 Front



Photo 7 Front (with paper cassette inserted)



Photo 8 Battery Pack NB-CP2L

2-2 5-dimensional Diagram

• SELPHY CP710

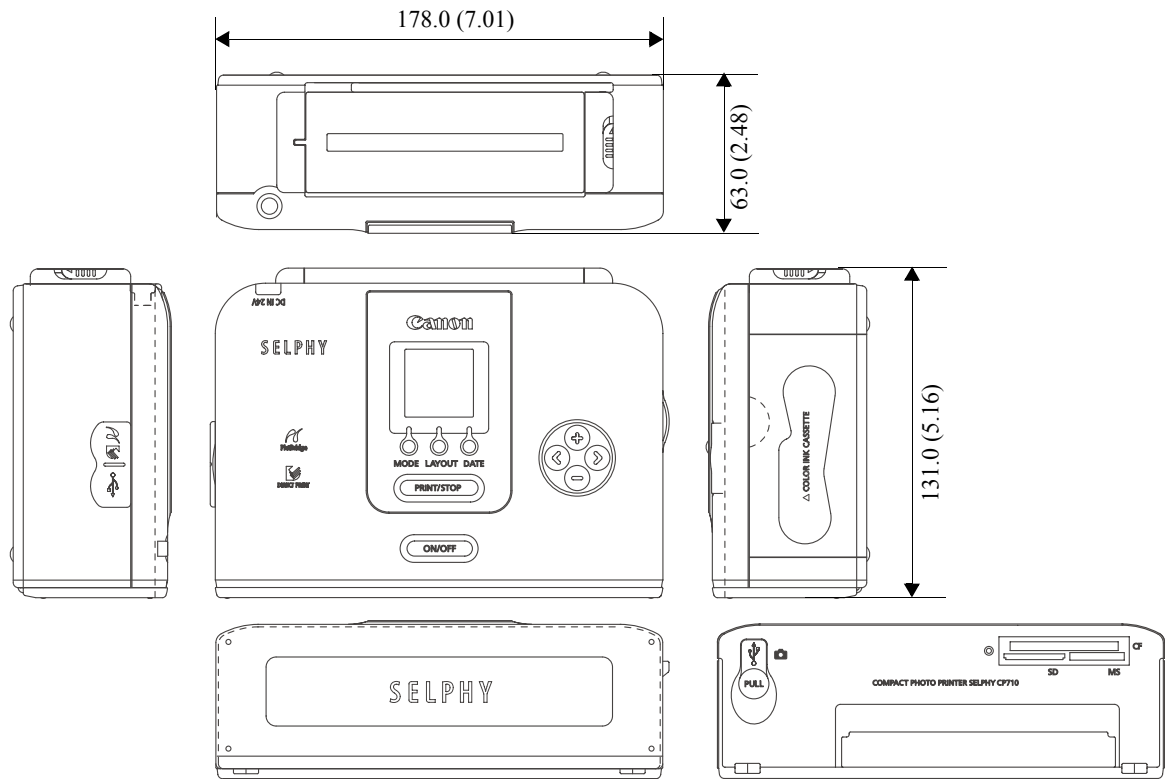

• SELPHY CP510

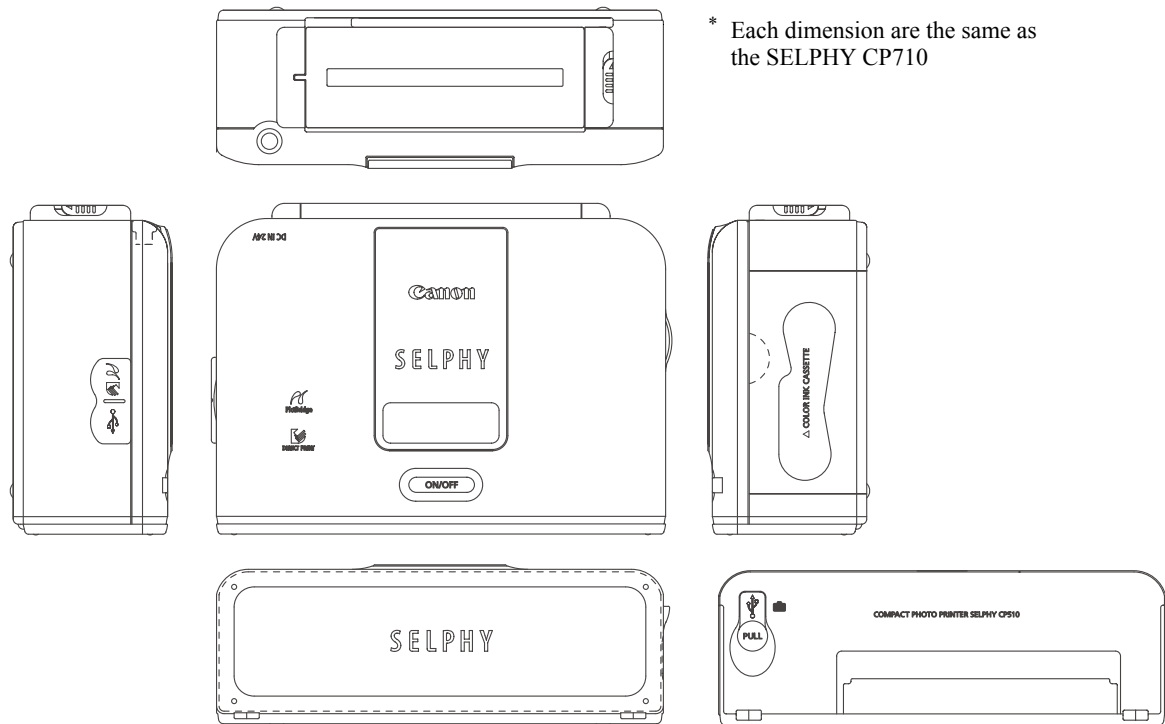

* Each dimension are the same as the SELPHY CP710

Unit: mm (inch)

2-3 Nomenclature

* SELPHY CP710 only

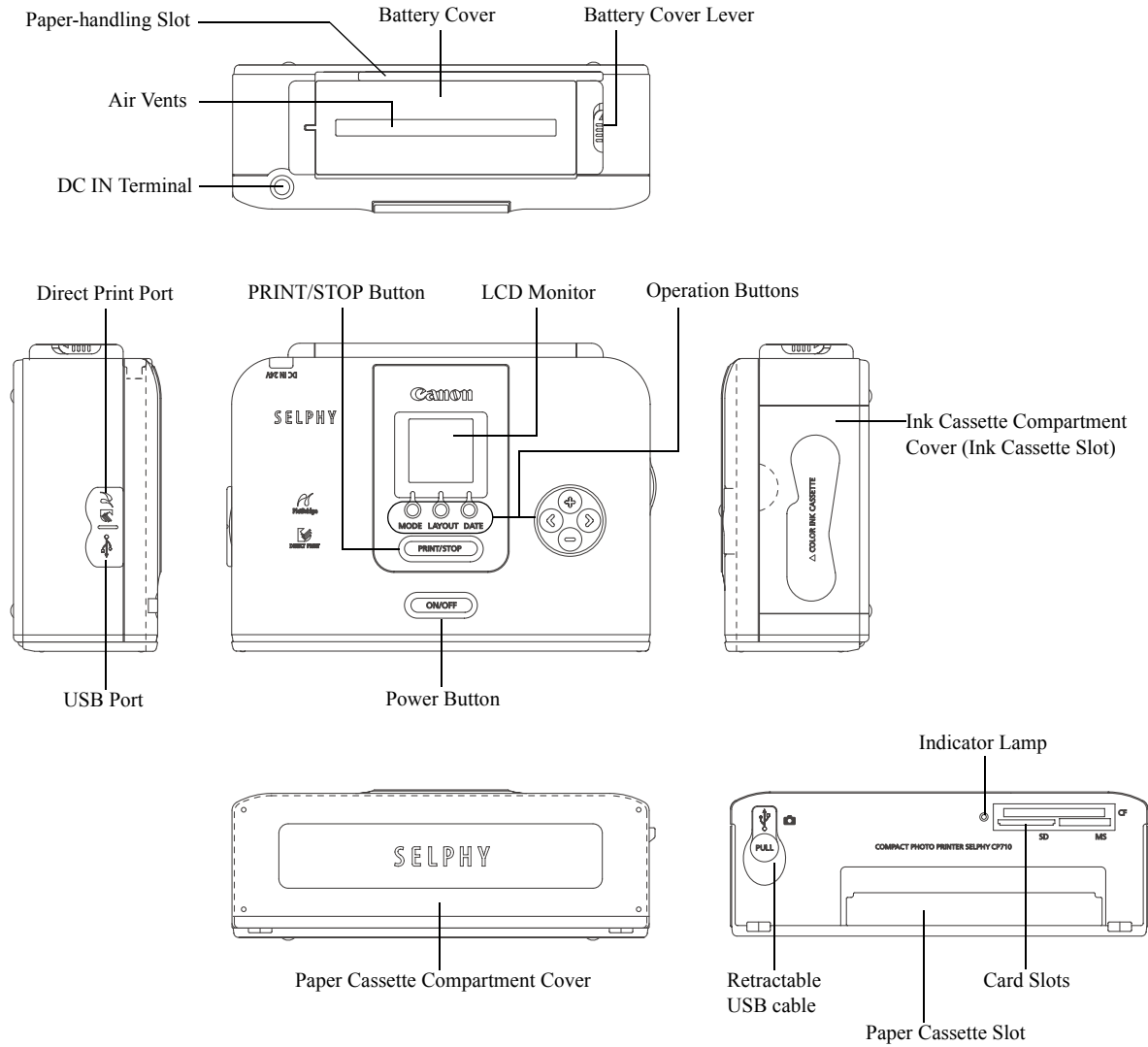

3 Specifications

3-1 Product Specifications

General Specifications

Printing Method	Dye-sublimation thermal print method (with overcoating)
Print Resolution	300 × 300 dpi
Gradation	256 levels per color
Ink	Dedicated cartridge (Y, M, C and overcoating material)
Paper (Size)	Dedicated paper <ul style="list-style-type: none"> • Postcard size : 100.0 × 148.0 mm (3.94 × 5.83 in.) • L size : 89.0 × 119.0 mm (3.50 × 4.69 in.) • Credit-card size (including label paper) : 54.0 × 86.0 mm (2.13 × 3.39 in.) • 8-piece stickers (per one label)) : 22.0 × 17.3 mm (0.87 × 0.68 in.) • Wide size : 100.0 × 200.0 mm (3.94 × 7.87 in.)

Print Size Unit: mm (inch)

	Borderless	Bordered*
Postcard size	100.0 × 148.0 (3.94 × 5.83 in.)	91.4 × 121.9 (3.60 × 4.80 in.)
L size	89.0 × 111.9 (3.50 × 4.69 in.)	79.2 × 105.3 (3.12 × 4.15 in.)
Credit-card size (including label paper)	54.0 × 86.0 (2.13 × 3.39 in.)	50.0 × 66.7 (1.97 × 2.63 in.)
8-piece stickers	22.0 × 17.3 (0.87 × 0.68 in.) (per one label)	—
Wide size	100.0 × 200.0 (3.94 × 7.87 in.)	91.4 × 121.9 (3.60 × 4.80 in.)

* The Bordered option prints photos at their original aspect ratio.

The values in the table are for images shot at the 4:3 aspect ratio with models from the PowerShot series and IXY DIGITAL series.

Print Time
(Standard Resolution/Normal
Temperature)

	Canon Direct Print		Canon Direct Print (from a memory card) (SELPHY CP710 only)	PictBridge
	Camera equipped with DIGIC II	Camera equipped with DIGIC		
Postcard size	Approx. 58 sec.	Approx. 68 sec.	Approx. 85 sec.*	Approx. 85 sec.*
L size	Approx. 50 sec.	Approx. 54 sec.	Approx. 73 sec.*	Approx. 73 sec.*
Credit-card size	Approx. 31 sec.	Approx. 33 sec.	Approx. 44 sec.*	Approx. 44 sec.*
8-piece stickers	Approx. 31 sec.	Approx. 33 sec.	Approx. 44 sec.*	Approx. 44 sec.*
Wide size	Approx. 74 sec.	Approx. 80 sec.	Approx. 105 sec.*	Approx. 105 sec.*

* Reference value

Print time is varied according to digital camera's recording pixels and memory card's sorts or capacity.

Number of Prints (with the Battery Pack NB-CP2L)	Postcard size : 36 or more L size : 36 or more Credit-card size : 72 or more 8-piece stickers : 72 or more Wide size : 24 or more* *When borderless print
--	--

Feeding System	Automatic (Dedicated cassette)
Paper Eject System	Ejects on the paper cassette

Printing Specifications

Printing Modes

Printing Modes	Canon Direct Print (from a camera)		Canon Direct Print (from a memory card)
	Canon Direct Print	PictBridge	
Single Image Print	Yes	Yes	Yes
Several Selected Images Print	Yes (with DPOF images)	Yes	Yes
DPOF Image Print	Yes	Yes	Yes
All Image Index Print	Yes (with DPOF images)	Yes	Yes
All Image Print	Yes (with DPOF images)	Yes	Yes
Cropping Print	Yes	Yes	No
Copies	Yes (up to 99)	Yes (up to 99)	Yes (up to 99)
Date Print	Yes	Yes	Yes
Paper Size	No	Yes	No
Layout print (fixed size)	No	Yes	No
Layout print (N-up)	Yes (only with 8-piece stickers)	Yes	Yes (only with 8-piece stickers)
File Name Print	Yes (Only DPOF File Number)	Yes	Yes (Only image number during Index Print)
Borderless	Yes	Yes	Yes
Image Optimization (Automatic dynamic-range correction)	No*	Yes	Yes
ID Photo Print	Yes	No	No
Movie Print (frame-by-frame)	Yes	No	No

 Canon-only features

* Camera controls so as to achieve an optimal image quality.

Image Quality Adjustment

Not supported

- With PictBridge and Canon Direct Print (from a memory card), image optimization (automatic dynamic-range correction) is available.

Exif Print

Not supported

Interface

USB

Type A connector: Camera connection
Cable in the printer (mini-B plug on the camera end): Camera connection
Type B connector: Computer connection

Wireless

Bluetooth

- Optional Bluetooth Unit BU-20 required

IEEE 802.11b

- Optional Wireless Print Adapter WA-1(N)(E) required

Memory Card

SD memory card
Compact Flash card
Memory Stick

- Three slots
- Other memory cards with a compatible configuration can be used.
- Maximum playable pixels: 8,000 × 6,000 pixels

Video Input/output

Not supported

Product Specifications

Operating Environment

5 - 40°C, 20 - 80% RH

Power Source

DC 24 V
Compact Power Adapter CA-CP200

Power Consumption

60 W or less (Standby: 4 W or less)

Dimensions

SELPHY CP710/CP510: 178.0 × 131.0 × 63.0 mm (7.01 × 5.16 × 2.48 in.)

Weight (Printer only)

SELPHY CP710: Approx. 980 g (34.6 oz.) /CP510: Approx. 940 g (33.2 oz.)

3-2 System Diagram

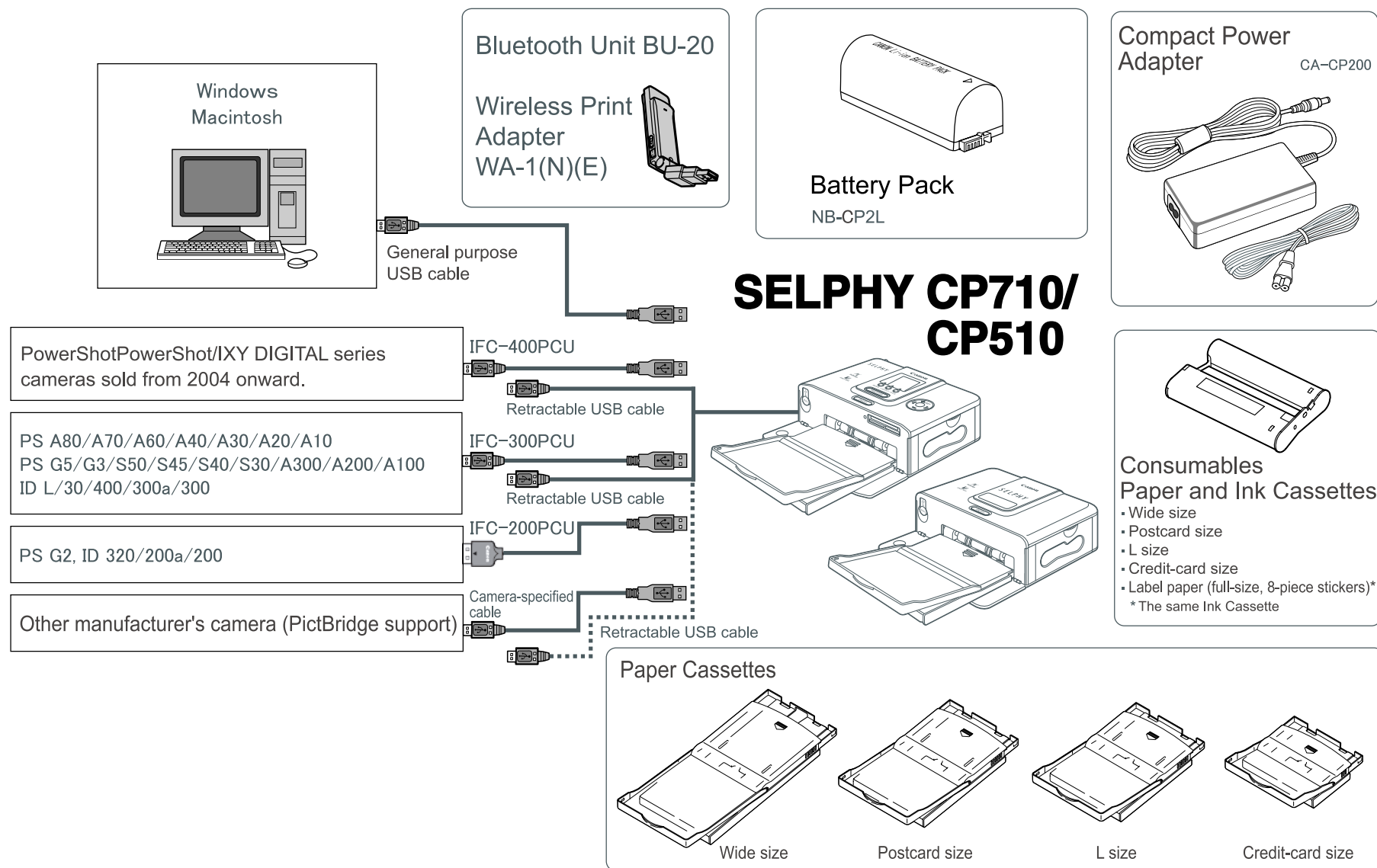

3-3 Direct Print

3-3-1 PictBridge Features and Corresponding Camera Support

The Table 1 and Table 2 show PictBridge features and corresponding camera support of PowerShot and IXY DIGITAL series.

When connected to a printer that is not compliant with a particular feature, the feature is not displayed on the camera's LCD monitor even if the feature is supported.

PictBridge Features	Cameras						Remarks
	PS Pro1 PS G6/G5 PS S70/S60/S50/ S1 IS PS A95/A85/A80/A75/ A70/A60 PS A400/A310/A300 ID 500/450/400/30a/30/L	ID 50/40 ID L ² PS A520/ A510	ID 600 ID 55	PS S2 IS	ID L ³ / 60/700 PS A620/ A610/ A410	PS S80	
1. Basic Print							
1. Single Image Print	○	○	○	○	○	○	
2. Several Selected Images Print	○	○	○	○	○	○	Diversion of DPOF information
3. DPOF AUTPRINT Images Print	○	○	○	○	○	○	Diversion of DPOF information
4. All Images Index Print	○	○	○	○	○	○	Diversion of DPOF information
5. All Images Print	○	○	○	○	○	○	Diversion of DPOF information
2. Advanced print setup							
1. Cropping Print	○	○	○	○	○	○	
2. Copies	○	○	○	○	○	○	
3. Date Print	○	○	○	○	○	○	
4. Paper Size	○	○	○	○	○	○	Refer to the “Table 2” of the following page.
5. Layout Print (Fixed Size)	×	×	○	○	○	○	
6. Layout Print (Multiple Images)	×	○	○	○	○	○	
7. File Name Print	△	△	○	○	○	○	△ means file number only when DPOF
8. Borderless	○	○	○	○	○	○	
3. Printer status information							
1. DPS Connection Established	○	○	○	○	○	○	
2. Error Occurred	○	○	○	○	○	○	
3. Error Status	○	○	○	○	○	○	
4. Job Status	○	○	○	○	○	○	
5. Cable Disconnect Enable	×	×	×	×	×	×	
6. Job Finish	○	○	○	○	○	○	
4. Printer setup							
1. Print Quality	×	×	×	×	×	×	
2. Paper Type	○	○	○	○	○	○	Refer to the “Table 2” of the following page.
5. Print job control							
1. DPS Print Cancel From DSC	○	○	○	○	○	○	
2. DPOF Cable Disconnect Recovery	○	○	○	○	○	○	Diversion of DPOF information
3. Paper Out Recover Trigger in Printer	-	-	-	-	-	-	Printer Feature
4. Error Recover UI in DSC	○	○	○	○	○	○	
"Image Optimize"							
Default / Off / On	○	○	○	○	○	○	
"Vivid"	○	○	○	○	○	○	
"NR"	○	○	○	○	○	○	
"Vivid+NR"	○	○	○	○	○	○	
"Face brightness adjustment"	×	×	×	×	○	○	
ID Photo Print	×	×	○	○	○	○	
Movie Print (Sequence)	×	×	○	○	○	○	
Movie Print (Single)	×	×	×	○	×	○	
Print with Shooting Data	×	×	×	×	○	○	

○ : Available △ : Conditionally available × : Not available

○ : Canon's original feature. Only available on supported Canon ink-jet printers (PIXMA series).

○ : Canon's original feature. Only available on Canon CP Printer (CP600) when in PictBridge connection.

○ : Only available on Canon CP Printer (CP600) when in PictBridge connection.

Table 1 PictBridge features and corresponding camera support

Paper Specifications		Cameras			
Paper Size	Paper Type	PS G5 PS S50 PS A80/A70/A60 PS A310/A300 ID 400 ID 30 ID L	PS Pro1 PS G6 PS S70/S60/S1 IS PS A95/A85/A75 PS A400/A310 PS A520/A510 ID 500/450/50/40/30a/L ²	ID 600 ID 55 PS S2 IS	ID L ³ /60/700 PS A620/A610/ A410/S80
Default	Plain	○	○	○	○
	Photo	○	○	○	○
	Fast Photo	○	○	○	○
	Default	○	○	○	○
89.0 X 127.0 mm	Plain	○	○	○	○
	Photo	○	○	○	○
	Fast Photo	○	○	○	○
	Default	○	○	○	○
127.0 X 178.0 mm	Plain	○	○	○	○
	Photo	○	○	○	○
	Fast Photo	○	○	○	○
	Default	○	○	○	○
100.0 X 148.0 mm	Plain	○	○	○	○
	Photo	○	○	○	○
	Fast Photo	○	○	○	○
	Default	○	○	○	○
Creditcard / 54.0 X 86.0mm	Plain	○	○	○	○
	Photo	○	○	○	○
	Fast Photo	○	○	○	○
	Default	○	○	○	○
4" X 6" 101.6 X 152.4 mm	Plain	○	○	○	○
	Photo	○	○	○	○
	Fast Photo	○	○	○	○
	Default	○	○	○	○
8" X 10" 203.2 X 254.0 mm	Fast Photo	×	×	×	○
	Default	×	×	×	○
Letter 216.0 X 279.4 mm	Plain	○	○	○	○
	Photo	○	○	○	○
	Fast Photo	○	○	○	○
	Default	○	○	○	○
11" X 17" 279.4 X 421.8 mm	Plain	×	○	○	○
	Photo	×	○	○	○
	Fast Photo	×	○	○	○
	Default	×	○	○	○
A3 297.0 X 420.0 mm	Plain	×	○	○	○
	Photo	×	○	○	○
	Fast Photo	×	○	○	○
	Default	×	○	○	○
A4 210.0 X 297.0 mm	Plain	○	○	○	○
	Photo	○	○	○	○
	Fast Photo	○	○	○	○
	Default	○	○	○	○
Roll 9 cm / Roll 13 cm / Roll 4" (10 cm) / Roll 21 cm	Plain	○	○	○	○
	Photo	○	○	○	○
	Fast Photo	○	○	○	○
	Default	○	○	○	○
5" X 7"	Photo	○	○	○	○
	Default	○	○	○	○
8.9 X 25.4 cm	Photo	○	○	○	○
	Default	○	○	○	○
A3+/ 13" X 19"	Photo	×	○	○	○
	Fast Photo	×	○	○	○
	Default	×	○	○	○
Wide(4" X 8")	Default	×	×	○	○
10" X 12** 254.0 X 304.8 mm	Fast Photo	×	×	×	○
	Default	×	×	×	○

○ : Canon's original feature. Only available on supported Canon ink-jet printers (PIXMA series).

■ : Canon's original feature. Only available on Canon CP Printer (CP600).

*: Not available on Canon ink-jet printers (PIXMA series) released in the 2nd half of 2005.

Table 2 Paper size / Paper type and corresponding camera support

3-3-2 The Connection between Digital Cameras and Printers

The connection between Canon digital cameras (PowerShot series and IXY series) and printers shows in Table 3.

Digital Cameras Printers		Canon Direct Print / Bubble Jet Direct / PictBridge support		Canon Direct Print / Bubble Jet Direct support	Canon Direct Print support
		ID L ³ /60/700, PS A620/A610/A410/S80 PS G5/S50/A80/A70/A60/A300/ S1 IS/S2 IS/Pro1, ID 600/400/55/30/L	Cameras released in 2004 (Except for PS Pro1, PS S1 IS) PS A520/A510	PS G3/G2/S45/S40/S30, ID 320/300a/200a	PS A40/A30/A20/A10/ A200/A100, ID 300/200
CP series (Canon Direct Print support)		Canon Direct Print			
SELPHY CP series	CP710/510 CP500/400				
	CP600				
PIXMA series (Bubble Jet Direct support)		PictBridge			–
PIXMA series (Bubble Jet Direct, PictBridge support)					–
SELPHY DS series (Bubble Jet Direct, PictBridge support)					–
Other manufacturer's Printer (PictBridge support)					–

- The supporting digital cameras and printers are included by improvement of the version of the firmware.
- IXY (ID) is the name for Japanese market.

Table 3 The connection between Digital Cameras and Printers

4 Accessories

4-1 List of Accessories

4-1-1 Ink, paper

- Postcard size: KP-36IP
- L size: KL-36IP
- Credit-card size: KC-36IP
- Full-sized label paper (credit-card size): KC-18IF
- 8-piece sticker sheet (credit-card size): KC-18IL
- Wide size: KW-24IP

4-1-2 Paper Cassettes

- Postcard size: PCP-CP100
- L size: PCL-CP100
- Credit-card size: PCC-CP100*
- Full-sized label paper (credit-card size): PCC-CP100*
- 8-piece sticker sheet (credit-card size): PCC-CP100*
- Wide size: PCW-CP100

* Domestic Japanese model has a switch to change between full-sized labels and 8-piece stickers.

4-1-3 Battery Pack

- NB-CP2L

4-1-4 Compact Power Adapter

- CA-CP200

4-1-5 Bluetooth Unit

- BU-20

4-1-6 Wireless Adapter

- WA-1(N)(E)

4-2 Accessory Compatibility

	CP710 CP510	CP600	CP500 CP400	CP330	CP220	CP-300	CP-200	CP-100	CP-10
--	----------------	-------	----------------	-------	-------	--------	--------	--------	-------

<Ink, paper>

HC-36IP	—	—	—	—	—	—	—	—	Yes
HC-18IP	—	—	—	—	—	—	—	—	Yes
HC-18IL	—	—	—	—	—	—	—	—	Yes
KP-36IP	Yes	Yes	Yes	Yes	Yes	Yes	Yes	Yes	—
KL-36IP	Yes	Yes	Yes	Yes	Yes	Yes	Yes	Yes	—
KC-36IP	Yes	Yes	Yes	Yes	Yes	Yes	Yes	Yes	—
KC-18IL	Yes	Yes	Yes	Yes	Yes	Yes	Yes	Yes	—
KC-18IF	Yes	Yes	Yes	Yes	Yes	Yes	Yes	Yes	—
KW-24IP	Yes	Yes	Yes	Yes	Yes	—	—	—	—

<Cable>

DIF-100	—	—	—	—	—	—	—	Yes	Yes
DIF-200	—	—	—	—	—	—	—	Yes	Yes
IFC-200PCU	Yes*	Yes*	Yes*	Yes*	Yes*	Yes*	Yes*	—	—
IFC-300PCU	Yes*	Yes*	Yes*	Yes*	Yes*	Yes*	Yes*	—	—
IFC-400PCU	Yes*	Yes*	Yes*	Yes*	Yes*	Yes*	Yes*	—	—

<Power Supply>

CA-CP100	—	—	—	Yes	Yes	Yes	Yes	Yes	Yes
CBA-CP100	—	—	—	Yes	—	Yes	—	Yes	Yes
CA-CP200	Yes	Yes	Yes	—	—	—	—	—	—
NB-CP1L	—	—	—	Yes	—	Yes	—	Yes	—
NB-CP2L	Yes	Yes	—	Yes	—	Yes	—	Yes	—

* For use with Canon digital cameras and video cameras that support Canon Direct Print.

When connecting by PictBridge with another manufacturer's camera, use the cable specified for that camera.