

SB Number:	SB 2GR-038	Creation Date: 01/04/2010
Subject:	Adding the film shield to prevent MCH leakage	
Model:	KM-3050/4050/5050, TASKalfa420i/520i	

If the humidifier like ultrasonic type is installed near the machine, moisture and minerals contained in the tap water may affect the machine. Please instruct the user to keep it away from the machine and ensure that the diffuser is not directed at the machine.

The ultrasonic humidifier spreads minute water particles by vibration at an ultrasonic frequency and minerals in the water also spread over the air. The minerals may contaminate the housings of the machine to look white and contaminate the main charger wire inside the machine

Please clean the non-cleaned area on the main charger wire regularly by the procedure below.

*If the minerals are absorbed in the machine, they accumulate along the main charger wire. In case the minerals unevenly accumulate where is not cleaned by the main charger cleaner on the main charger wire, the main charge may leak to the non-accumulated point. This causes the full-page solid image.

Therefore the **film shield** 302GR11510 (8.2m x 14mm, t=0.1mm) has been attached on the MCH shield to withstand voltage margin and decrease the accumulation of the minerals by limiting the electric discharge.

Cross section of the drum section.

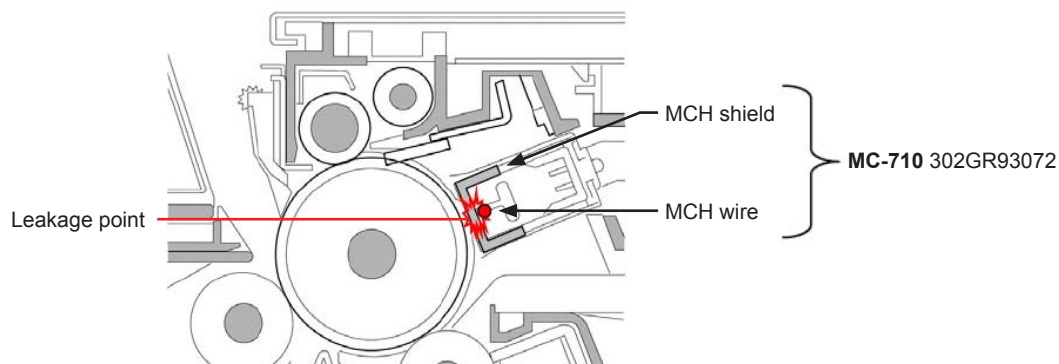

The abnormal image may be printed because the surface potential is not temporarily put on the drum, when the leakage to the MCH shield occurs.

MCH unit after separation

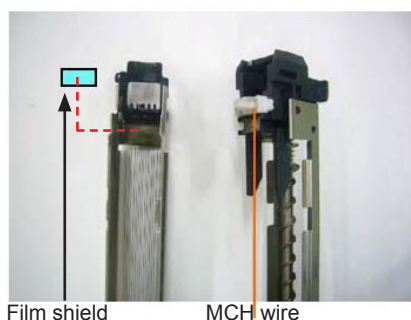

Cross section of the MCH unit after separation

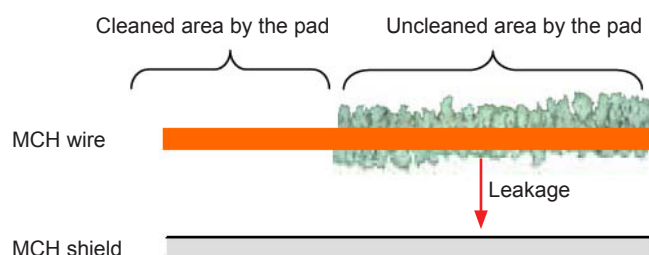

Classification	<input type="checkbox"/> Entire stock rework	<input type="checkbox"/> In-field modification at next visit	<input type="checkbox"/> In-field modification by case	<input checked="" type="checkbox"/> No modification necessary
Field measure	<p>When the above mentioned phenomenon occurs, please clean the non-cleaned area of the pad of the main charge wire and attach the film shield 302GR11510 on the MCH shield or replace the MC-710 with the latest type.</p> <p>Please do not point the ultrasonic humidifier at the machine and do not operate it to close to the machine. (See service bulletin 2GR-037 for further details)</p>			

Serial numbers of affected machines

Type	Serial number
KM-3050/4050/5050, TASKalfa420i/520i	December 2009 production.

Machines produced after the above mentioned production date, should not have the above mentioned phenomena.

Serial numbers of affected machines

No.	Old Parts No.	New Parts No.	Description	Q'TY		Interchange-ability		SP
				Old	New	Old	New	
1	302GN93011 2GN93011	302GN93012 2GN93012	DK-715 (For the KM-3050)	1	1	X	O	O
2	302GR93041 2GR93041	302GR93042 2GR93042	DK-716 (For the KM-4050 and TASKalfa420i/520i)	1	1	X	O	O
3	302GR94530 2GR94530	302GR94531 2GR94531	+PARTS MCH MOTOR SET ASSY	1	1	X	O	O
4	302GR93071 2GR93071	302GR93072 2GR93072	++MC-710	1	1	X	O	O
5	-----	302GR11510 2GR11510	+++FILM SHIELD	-	1	-	O	-

Cleaning the MCH wire and attaching the film shield

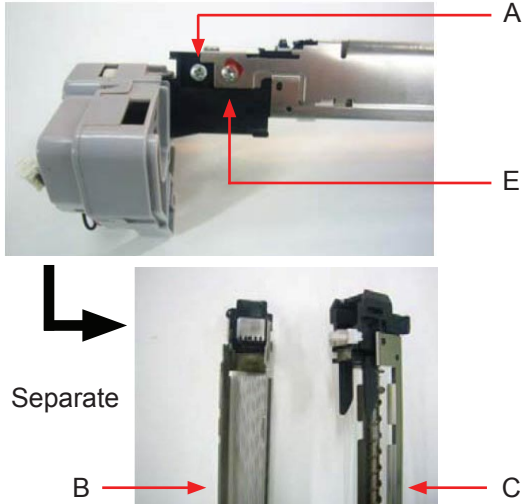
No.	Procedure	
1	<p>Pull out the MCH unit from the machine.</p> <p>Remove the screw (A) at the machine front side, separate the wire side (C) from the grid side (B).</p> <p>*Please do not to remove the screw with lock paint (E).</p>	 <p>The diagram illustrates the process of separating the MCH unit. The top image shows the unit with a screw labeled 'A' being removed. A label 'E' points to a lock paint area. The bottom image, labeled 'Separate', shows the unit split into two parts: the wire side (labeled 'C') and the grid side (labeled 'B').</p>

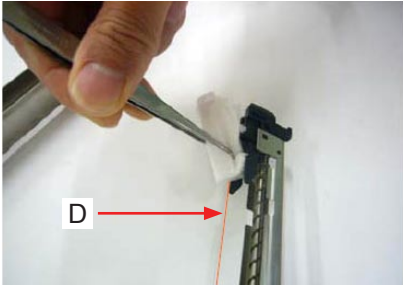
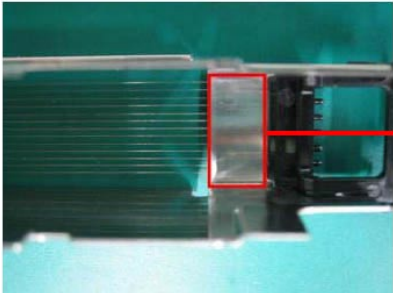
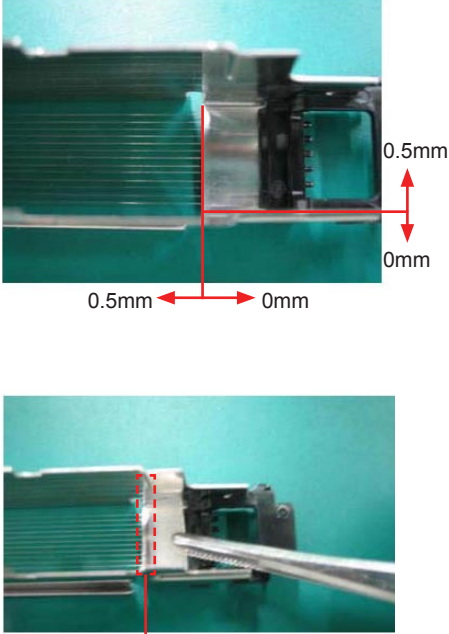
2	<p>Wire side(C)</p> <p>Pick up the non-cleaned area (D) on the MCH wire at the machine rear side with a soft cloth and slide it to clean several times to remove accumulation on the wire.</p>	
3	<p>Grid side (B)</p> <p>Clean the inside of MCH shield at the machine rear side (F) with water or alcohol by cloth or cotton swab.</p>	
4	<p>Attach the film shield according to the alignment. When aligned properly the double tape surface of the film shield makes contact with the grid border line and the MCH shield side.</p>	 <p>Film shield 302GR11510 Double sided tape (Blue).</p> 